



Thumb/Grip/Clamp Dimensional Form

Dear Valued Customer,

Thank you taking the time to complete this form. We at Werk-Brau understand that this is not always the easiest task to complete and truly appreciate your efforts. To be able to design and build your new grip/thumb/clamp to best fit your machine, operation and setup we require the following dimensional and information.

Please try to get each measurement $\pm 1/8"$. Getting us accurate measurements will greatly reduce the possibility of any issues with your thumbs installation and operation.

Please supply pictures if possible of your bucket and coupler.
This will greatly aid our engineers. (See page 4)

Thank you again for your help and business. We look forward to providing you with an exceptional attachment.

Good Selling,
The Werk-Brau Team
1-800-537-9561

COUPLER & BUCKET DIMENSIONS

If not a WB purchased coupler, please complete the following **OR** provide the manufacturers print. (You do not need to complete A-F if you have a coupler print)

- A. _____ Pin diameter
- B. _____ Widest point on ears
- C. _____ Pin retainer ear total width
- D. _____ Non pin Retainer ear total width
- E. _____ Inside ear spacing
- F. _____ Pin retainer width (edge to ear plate)
- CR. _____ Tip radius with bucket and coupler (N/A if no coupler)
- BR. _____ Tip radius of bucket

Please circle the following

- Pin retainer location **RIGHT** **LEFT** (shown in pic below)
- Hangers/Ears have Anti-Clatter **YES** **NO**
- Does your machine have an OEM Cylinder mount already? **YES** **NO**

Below view may be flipped from what you actually have

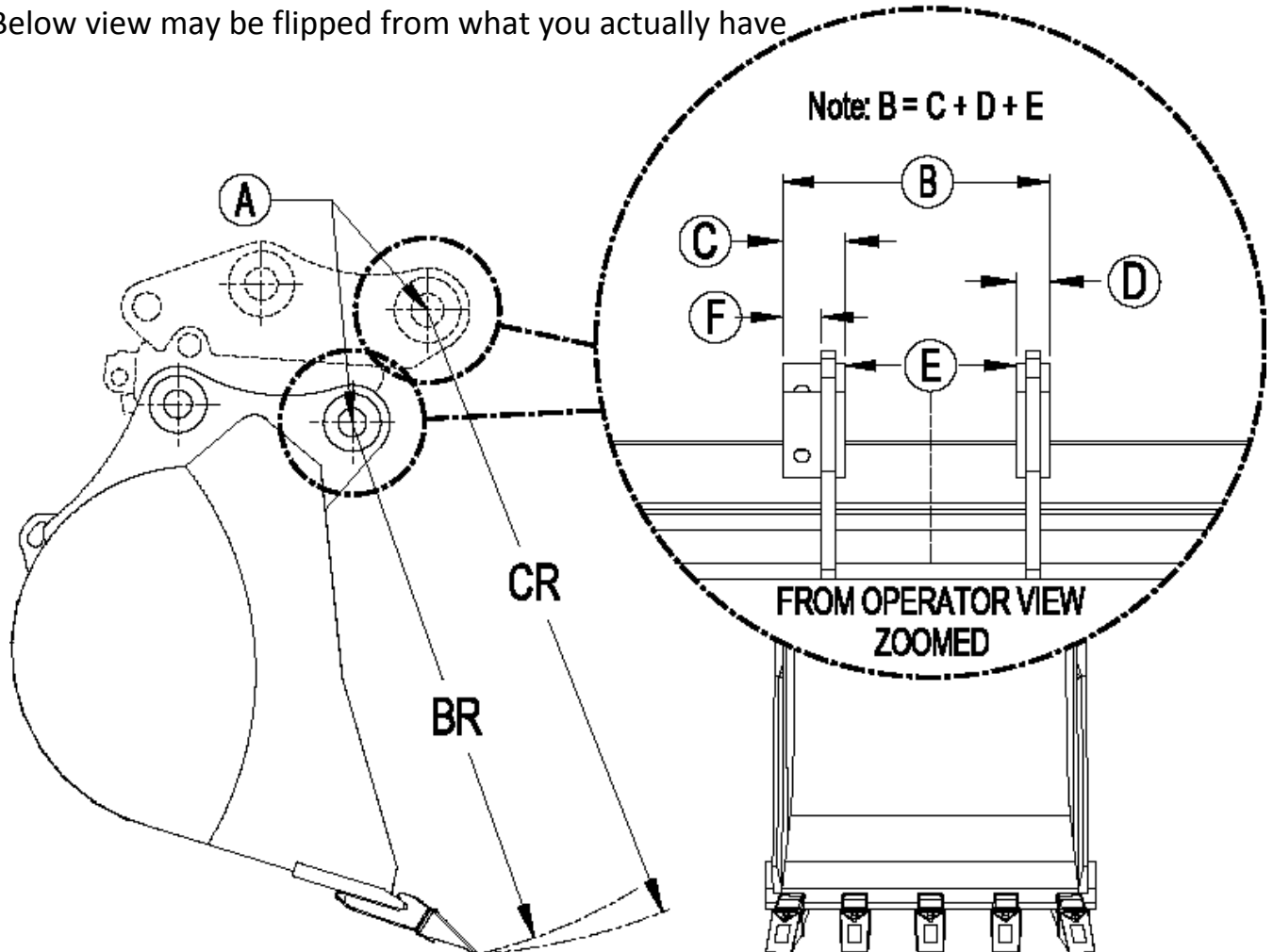

TOOTH DIMENSIONS

☐ 3 TEETH

3-a: _____
TOOTH WIDTH: _____
3 TOTAL: _____

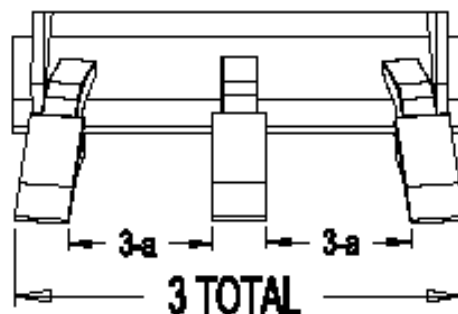

☐ 4 TEETH

4-a: _____
4-b: _____
TOOTH WIDTH: _____
4 TOTAL: _____

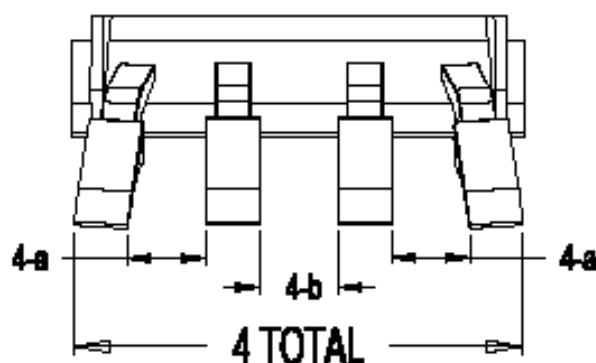

☐ 5 TEETH

5-a: _____
5-b: _____
TOOTH WIDTH: _____
5 TOTAL: _____

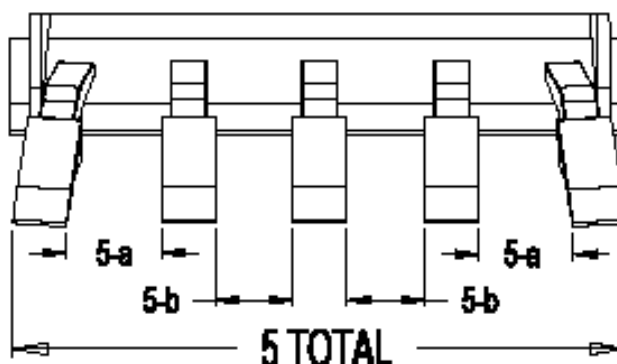

☐ 6 TEETH

6-a: _____
6-b: _____
TOOTH WIDTH: _____
6 TOTAL: _____

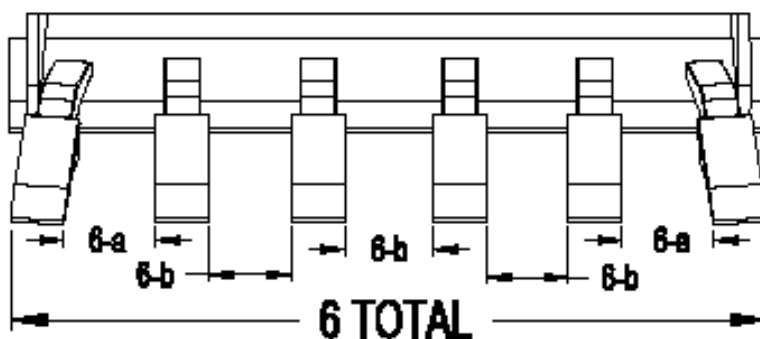

BUCKET PROFILE DIMENSIONS

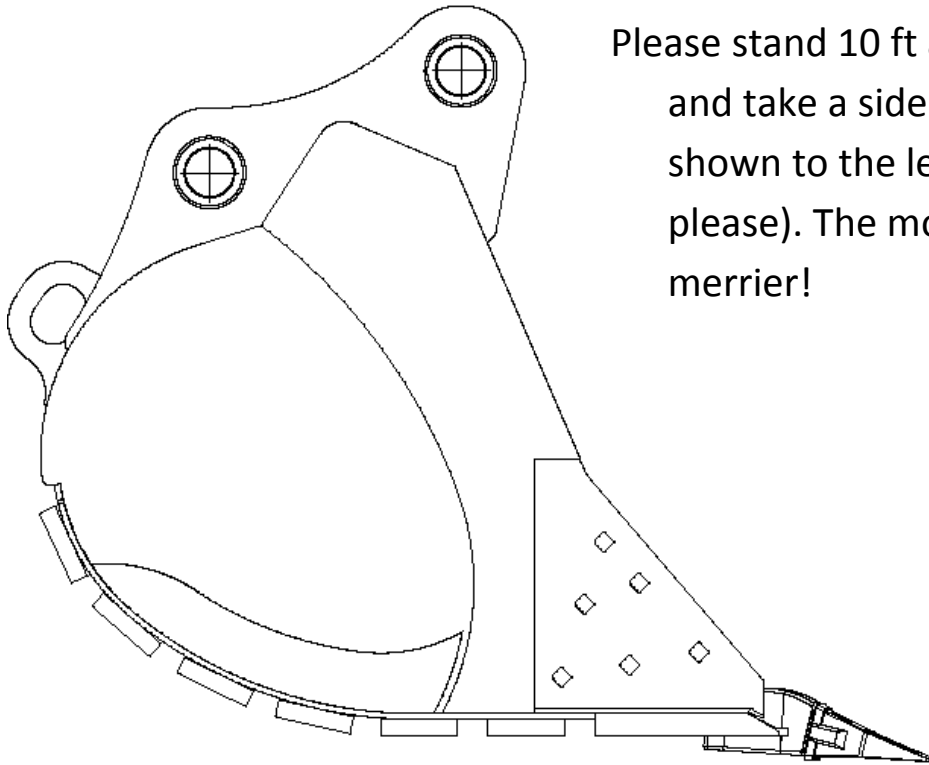

Please stand 10 ft away or so from bucket and take a side profile picture, like shown to the left (Not close up please). The more pictures the merrier!

Coupler Profile Dimensions

Please specify 1 of the 4 options to determine your coupler profile

- ☐ 1. No coupler
- ☐ 2. Werk-Brau Coupler SN _____
- ☐ 3. Print Provided
- ☐ 4. Complete form below
 - A. _____ Lower Center to Center
 - B. _____ Front Jaw to Stick pin hole offset horizontal
 - C. _____ Front Jaw to Stick pin hole offset vertical

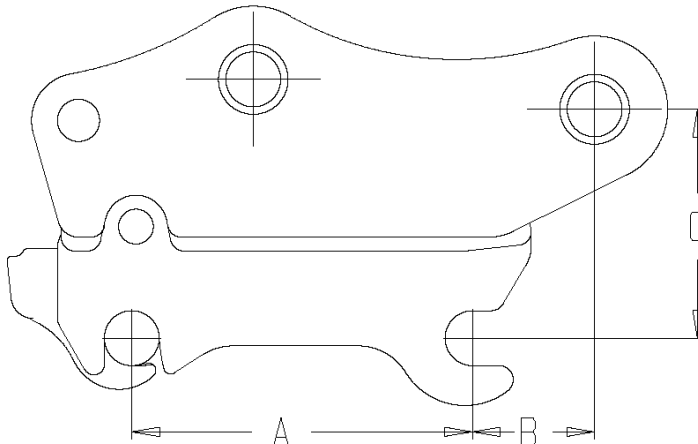

BUCKET PROFILE DIMENSIONS

Fully Curl Stick (transport position)

OEM specified stick length _____

SL. _____ Stick length from Pivot Pin to crowd point

SA. _____ 12" from stick and boom elbow to 12" on boom

SB. _____ 24" from stick and boom elbow to 24" on boom

SC. _____ 36" from stick and boom elbow to 36" on boom

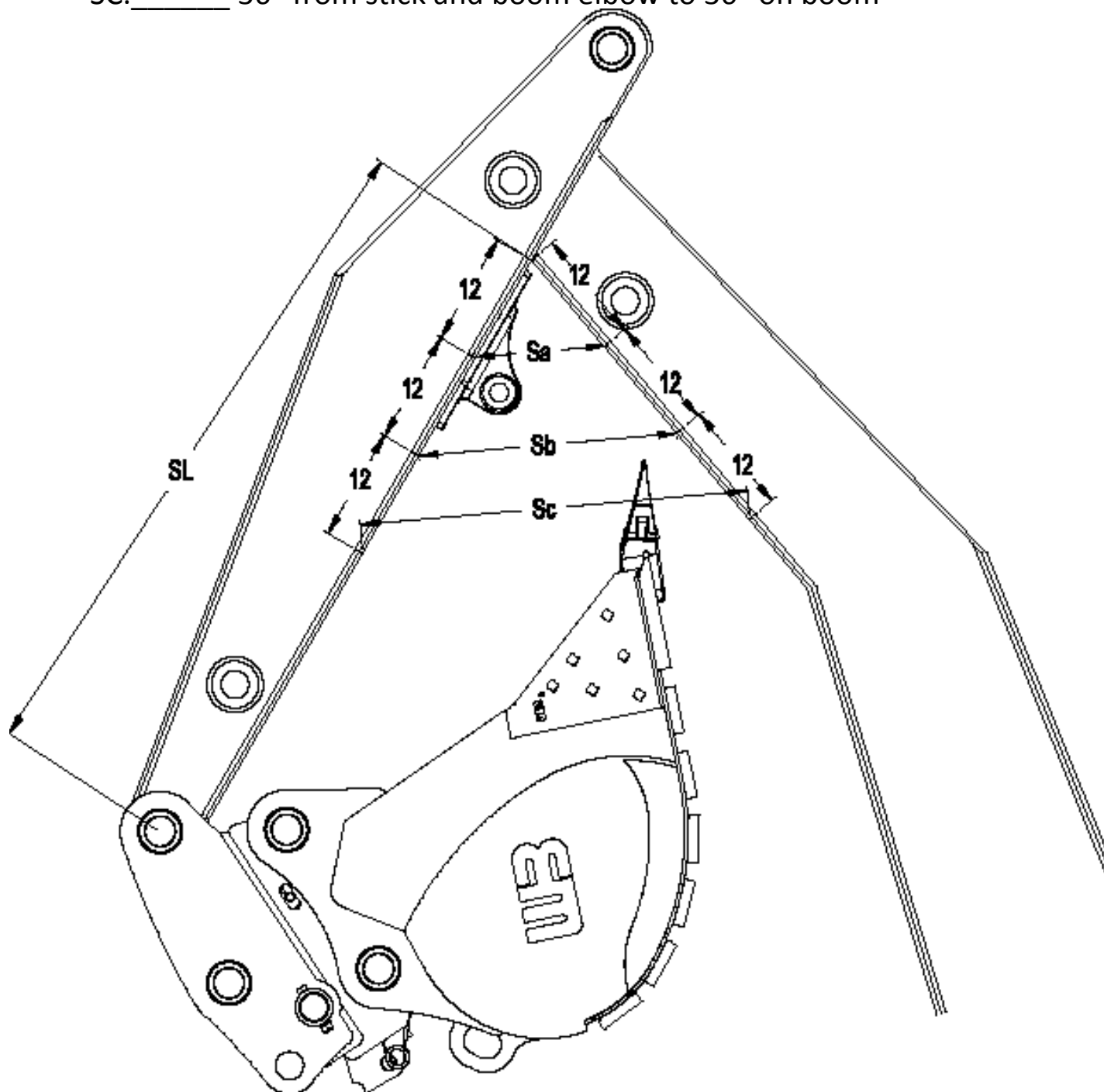

Thumb Hang Down Explained

Ever wonder why a thumb hangs as far off the stick when stored??

Reason: Thumbs/Grips/Clamps must match the geometry of the bucket and or coupler they are working with otherwise it will not meet the edge of the bucket

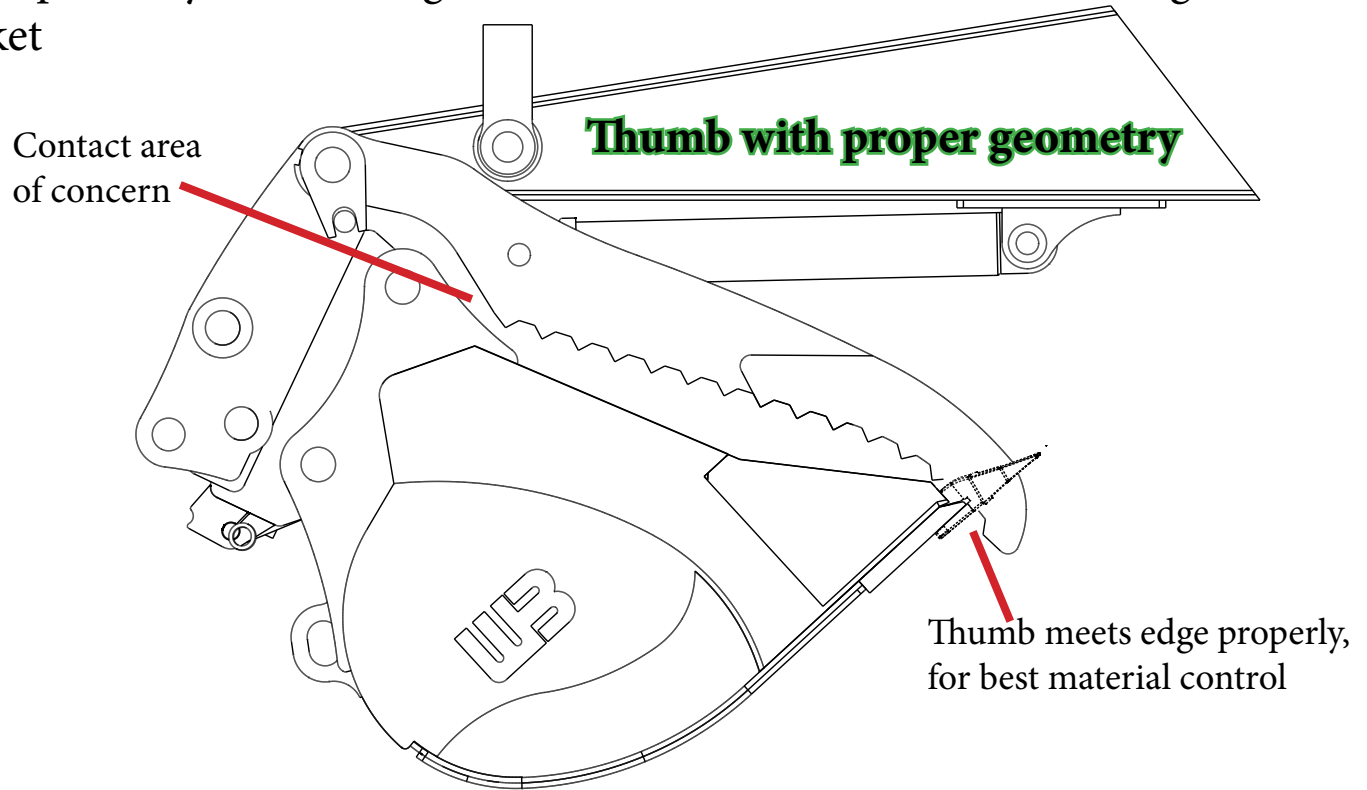

Thumb contacts bucket/coupler prematurely vs edge of bucket

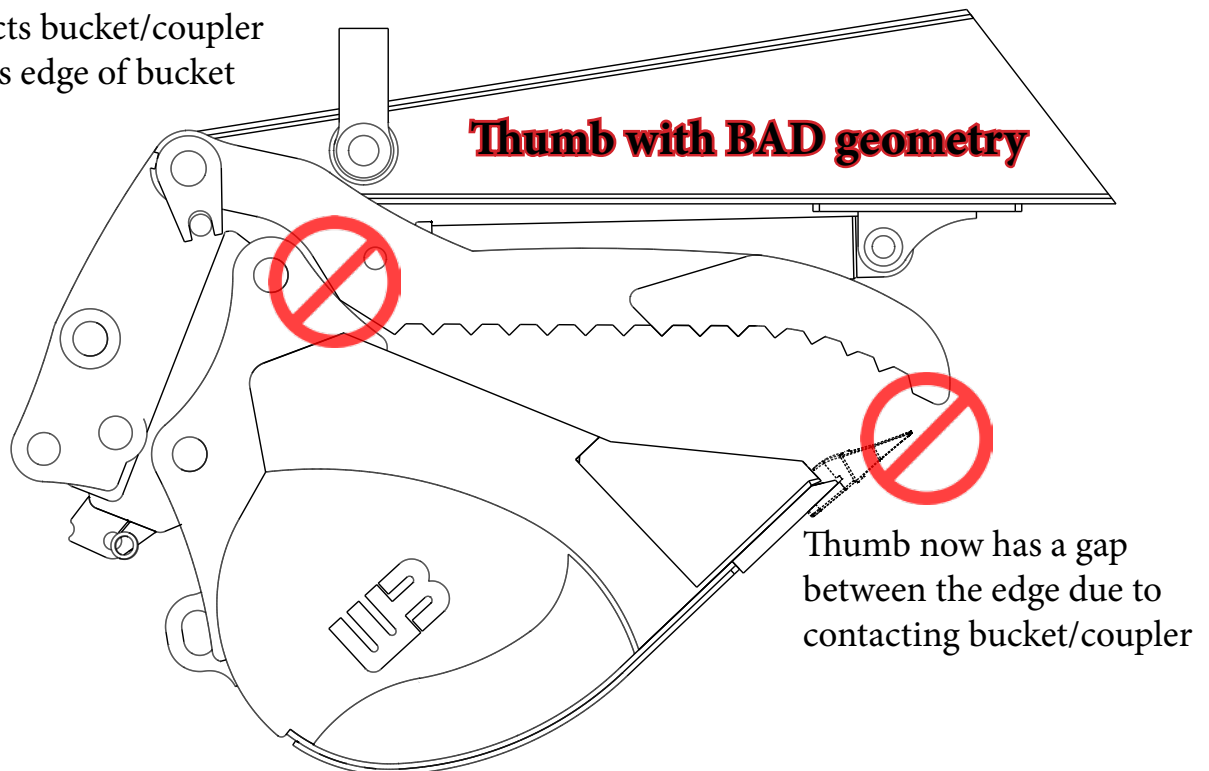

THUMB, COUPLER AND BUCKET INTERFERENCE WARNING

Valued Customer,

Unfortunately with some stick and attachment combination interference points occur. Below is a WARNING of possible interference situations. Werk-Brau cannot predict nor prevent all of these situations. Please contact us with any questions you may have.

Good Selling,
The Werk-Brau Sales Team
1-800-537-9561

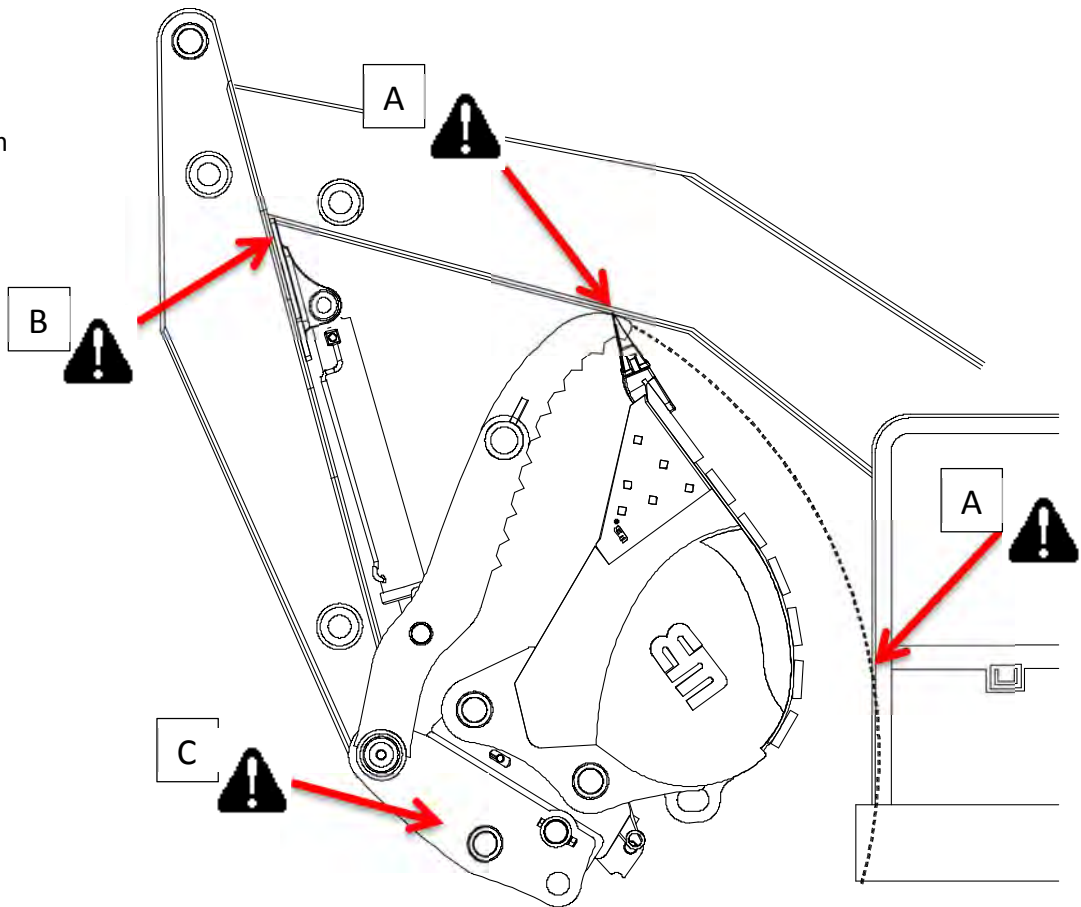

A: Due to the tip radius of the attachment(s) the thumb is working with the tines may hit on the boom or cab. In this case the other attachment(s) will as well.

Possible Solution: Trim the tines that are interfering. This is not a warrantable action and is a common practice

B: In certain stick lengths the cylinder mount may get into the crowd of the boom and stick.

Possible Solution: Trim the mount to clear or get a shorter cylinder (you will need to contact WB to swap cylinders)

C: When adding a coupler and especially a multi pin grabber coupler you greatly increase your chances of interference with boom. This is both with the bucket teeth and the thumb.

Possible Solution: Switch to a *scoop bucket* that the pins are integrated into the bucket. This will reduce the tip radius of your attachment combination significantly.

STICK MOUNTED THUMBS: Note that stick mounted thumbs have the same possibilities as the standard thumb shown above. Trimming the tines is a common practice with this style as well.

!!!OEM Mount: Please also let your sales rep know if your machine has an OEM mount you would like to utilize