

WERK-BRAU CO., INC. PRODUCT AND INSTALLATION MANUAL

SLQT / SQC Coupler

(Spring Loaded Coupler (manual) / Spring Loaded Hydraulic Coupler)

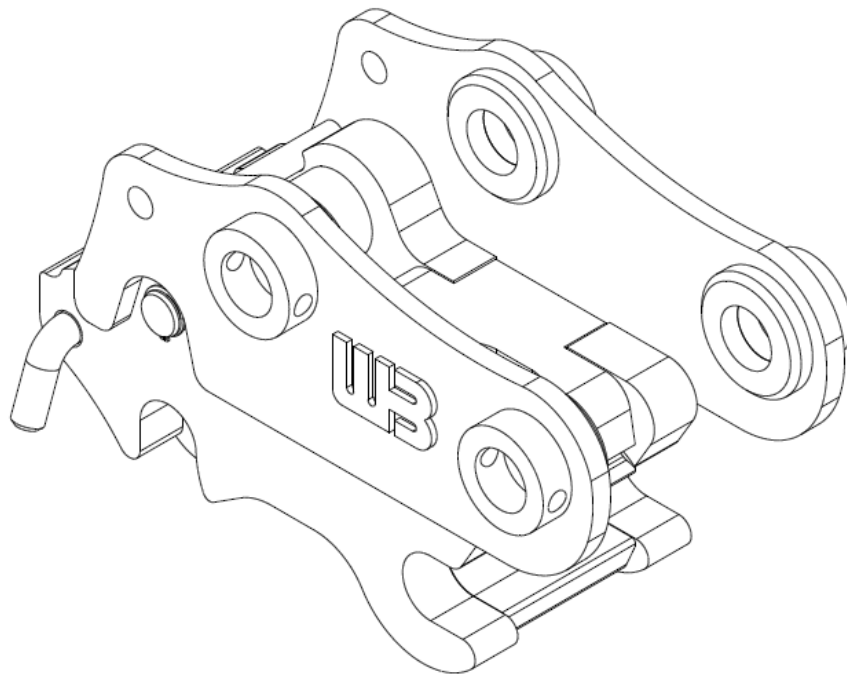

Serial No: _____

Model No: _____

Date Manufactured: _____

PROUDLY MANUFACTURED IN FINDLAY, OH
Werk-Brau.com



SAFETY STATEMENT GUIDE

DANGER

Danger tags are used in major hazard situations where an immediate hazard presents a threat of death or serious injury to operator and anyone about.

WARNING

Warning tags are used to represent a hazard level between “Caution” and “Danger”, instead of the required “Caution” tag, provided that they have a signal word of “Warning,” an appropriate major message.

CAUTION

Caution tags are used in minor hazard situations where a non-immediate or potential hazard or unsafe practice presents a lesser threat of injury.

NOTICE

A notice label is used where equipment or property damage could result if the instructions are not followed properly.



This symbol by itself or used with a safety signal word throughout this manual is used to call your attention to instructions involving your personal safety or the safety of others. Failure to follow these instructions can result in injury or death.

GENERAL SAFETY PRECAUTIONS

DANGER

READ MANUAL PRIOR TO INSTALLATION

Improper installation, operation, or maintenance of this equipment could result in serious injury or death. Operators and maintenance personnel should read this manual as well as all manuals related to this equipment and the operating machine thoroughly before beginning installation, operation, or maintenance. FOLLOW ALL SAFETY INSTRUCTIONS IN THIS MANUAL AND THE OPERATING MACHINES MANUAL.

WARNING

READ AND UNDERSTAND ALL SAFETY STATEMENTS

Read all safety decals and safety statements in all manuals prior to operating or working on this equipment. Know and obey all OSHA regulations, local laws and other professional guidelines for your operation. Know and follow good work practices when assembling, maintaining, repairing, mounting, removing or operating this equipment.

DANGER

KNOW YOUR EQUIPMENT

Know your equipment's capabilities, dimensions and operations before operating. Visually inspect your equipment before you start, and never operate equipment that is not in proper working order with all safety devices intact. Check all hardware to assure it is tight. Make certain that all locking pins, latches, and connection devices are properly installed and secured. Remove and replace any damaged, fatigued or excessively worn parts. Make certain all safety decals are in place and are legible. Keep decals clean, and replace them if they become worn and hard to read.

NOTICE

PROTECT AGAINST FLYING DEBRIS

Always wear proper safety glasses, goggles with a face shield when driving pins in or out or when any operation causes dust, flying debris, or any other hazardous material.

WARNING

LOWER OR SUPPORT RAISED EQUIPMENT

Do not work under raised booms without supporting them. Do not use support material made of concrete blocks, logs, buckets, barrels or any other material that could suddenly collapse or shift positions. Make sure support material is solid, not decayed, warped, twisted, or tapered. Lower the boom(s) to ground level or onto block(s). Lower the boom(s) and attachment(s) to the ground before leaving the cab or operator's station.

GENERAL SAFETY PRECAUTIONS

WARNING

USE CARE WITH HYDRAULIC FLUID PRESSURE

Hydraulic fluid under pressure can penetrate the skin and cause serious injury or death. Hydraulic leaks under pressure may not be visible. Before connecting or disconnecting hydraulic hoses, read your operating machines operator's manual for detailed instructions on connecting and disconnecting hydraulic hoses or fittings.

- Keep unprotected body parts, such as face, eyes, and arms as far away as possible from a suspected leak. Flesh injected with hydraulic fluid may develop gangrene or other permanent disabilities. Wear safety glasses, protective clothing, and use a sound piece of cardboard or wood when searching for hydraulic leaks. **DO NOT USE YOUR HANDS**
- If injured by injected fluid, see a doctor at once. If your doctor is not familiar with this type of injury, ask him to research immediately to determine proper treatment.

WARNING

DO NOT MODIFY MACHINE OR ATTACHMENTS

Modifications may weaken the integrity of the attachment and may impair the function, safety, life and performance of the attachment. When making repairs, use only the manufacturer's genuine parts, following authorized instructions. Other parts may be substandard in fit and quality. For loaders, never modify any ROPS (Roll Over Protection System) equipment or device.

!!!Any modifications must be authorized in writing by Werk-Brau or the manufacturer!!!

DANGER

NOTICE

SAFELY OPERATE THE EQUIPMENT

Do not operate equipment until you are completely trained by a qualified operator in how to use the controls, know its capabilities, dimensions, and all safety requirements.

See your operating machines manual for these instructions.

- Keep all step plates, grab bars, pedals, and controls free of dirt, grease, debris, and oil.
- Be sure that all bystanders are out of harms way when operating.
- Do not allow riders on the attachment or operating machine
- Do not operate the equipment from anywhere other than the correct operators position.
- Never leave equipment unattended with the engine running or with this attachment in a raised position.
- Do not alter or remove any safety feature from the operating machine or this attachment.
- Know your work site safety rules as well as traffic rules and flow. When in doubt on any safety issue, contact your supervisor or safety coordinator for an explanation.



SAFELY MAINTAIN AND REPAIR EQUIPMENT

- Do not wear loose clothing, or any accessories that can catch in moving parts. If you have long hair, cover or secure it so that it does not become entangled in the equipment.
- Work on a level surface in a well-lit area.
- Use properly grounded electrical outlets and tools.
- Use the correct tool for the job at hand. Make sure tools are in good condition.
- Wear all protective equipment specified by the tool manufacturer.

OPERATING PRECAUTIONS

WARNING

DO NOT IMPROPERLY USE THIS COUPLER

This coupler is designed to couple attachments and not for any other use.

DANGER

BE AWARE OF SURROUNDING UTILITIES

Operator must be aware of all utility line and overhead electrical lines. Operations must be able to clear all lines safely.

NOTICE

DANGER

BE AWARE OF OVERHEAD DANGER

Operator must be aware of all possible overhead dangers that are within the range of motion of the operating machine.

WARNING

DO NOT OPERATE WITH A LOOSE ATTACHMENT

Visually check the coupler to verify attachments are secure and lock is fully engaged and that the center to center of the attachment matches the up with the attachment.

WARNING

PINCH POINTS

Personal injury could result from the careless misuse of this coupler. Keep hands and body parts clear of the coupler when it's in the process of hooking up to an attachment. Be sure the machine is off and the attachment is on the ground prior to making adjustments.

NOTICE

COUPLER EXTENDS TIP RADIUS

Notice adding a coupler to a machine extends the tip radius. This can cause clearance issues on some machines making it possible for a coupled attachment to come into contact with the machine causing damage.



TABLE OF CONTENTS

P.O. Box 545 Findlay, Ohio 45839-0545

1-800-537-9561 *phone*

419-422-7207 *fax*

Werk-Brau.com

TITLE	PAGE
Introduction	6
Safety Pin Notice	7
Torque Specifications (SQC)	8
Installation	9
Connecting and Releasing an Attachment	10
Unlocked vs Locked	11
Releasing an Attachment	11
Decal Placement Guide	12
Maintenance	13
Spring Adjustment and Replacement	13
Troubleshooting	14

If at any time in the future, you require additional information on this product or any aspects of its use, please do not hesitate to contact Werk-Brau Co., Inc.

Thank you for your purchase. You have received a high quality coupler that will increase a machine's productivity and versatility by enabling the operator to quickly change from one attachment to another. If installed and maintained properly, it should provide years of service in a rugged environment.

Coupler Introduction

The coupler attaches onto various tools by "hooking" the front pin and then rotating a locking device under the rear pin of the attachment. The lock is self-adjusting, so no future adjustments are needed. While engaged, the SLQT lock is securely held in place by extension spring(s). The SQC lock is securely held in place by the cylinder and dual extension springs. All Werk-Brau SLQT & SQC couplers are equipped with powerful tension springs. In the event of spring failure, the coupler's safety

lock will enable the coupler to hold the attachment. To disengage the coupler lock, the operator must first remove the safety pin and the operator will set the attachment on the ground. For an SLQT, the operator uses the handle to release the lock. For an SQC, the operator uses a switch installed in the cab of the equipment.

After engaging the lock manually, install the safety pin and retaining

device (lynch pin). The safety pin must be installed at all times during use of the coupler. The safety pin is mandatory and serves two purposes. First, once installed it insures the operator that the lock is in fact properly seated under the pin. The safety pin can't be installed if the lock is only partially engaged. Second, it will prohibit inadvertent disengagement.

NOTE: Diagrams in this manual may not be your exact Werk-Brau coupler. These pictures represent an action or a setup.

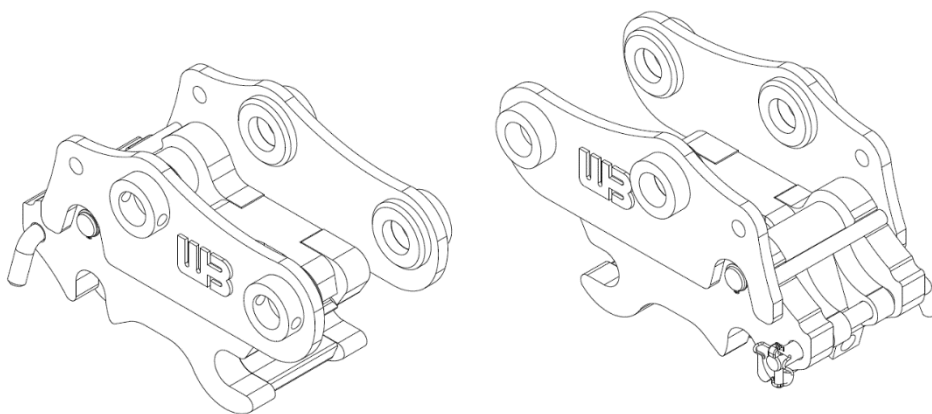

SAFETY PIN NOTICE

Werk-Brau has approved of the following safety retaining pins for use with all Werk-Brau couplers. Pins vary in size, please use the appropriate size approved safety pin on all couplers. Please only use the approved safety pins shown below.



Standard Variable Pin

Part # 00161397



Half Inch Pin

Part # EZG025RLP



TORQUE SPECIFICATIONS (SQC ONLY)

Dash Size	Tube O.D. (Ref)	Thread Size	37° Flare		Straight Thread	
			Ft-lbs	Nm	Ft-lbs	Nm
4	1/4	7/16-20	10-12	14-16	15-19	20-25
5	5/16	1/2-20	13-16	18-21	20-25	27-33
6	3/8	9/16-18	20-25	27-33	32-40	43-54
8	1/2	3/4-16	34-42	46-56	54-67	73-90
10	5/8	7/8-14	46-58	62-78	74-92	100-124
12	3/4	1-1/16-12	64-80	87-108	102-128	138-173
14	7/8	1-3/16-12	80-100	109-135	128-160	173-216
16	1	1-5/16-12	97-117	131-158	150-187	203-253
20	1-1/4	1-5/8-12	145-165	197-223	227-264	308-357
24	1-1/2	1-7/8-12	230-250	312-338	363-400	492-542

*Apply enough pipe sealer to contact all threads.

**Do not use an excess amount that will squeeze into the hydraulic lines.

INSTALLATION

Un-package the coupler from the shipping skid, remove attaching pins and orient the coupler so that the open mouth of the coupler is towards the machine.

1. Position and align the stick with the front bore on the coupler and install the machine's original front attaching pin. Do the same with the attachment link and install the original rear pin.
2. Install the pins provided with the coupler, into the attachment.
3. Secure and retain all pins.

IMPORTANT: Set the bucket on the ground and rotate in a dumping motion until the tracks come off the ground to check that the coupler has positively connected to the bucket. Do this every time attachment is changed.

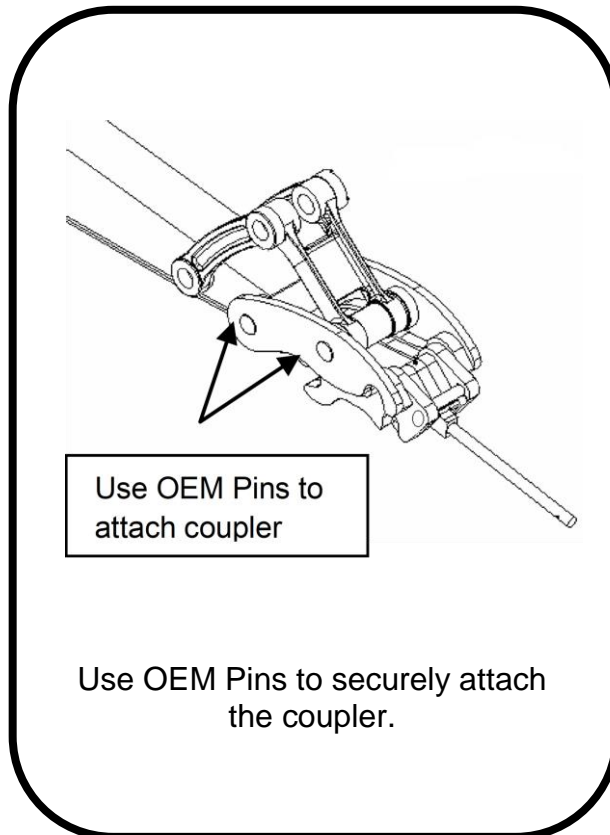



CONNECTING AND RELEASING AN ATTACHMENT

DECAL

MECHANICAL SPRING LOADED COUPLER

TO INSTALL THE ATTACHMENT

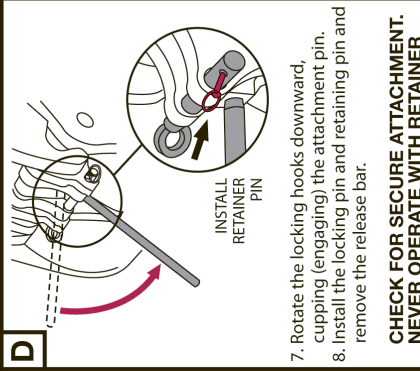
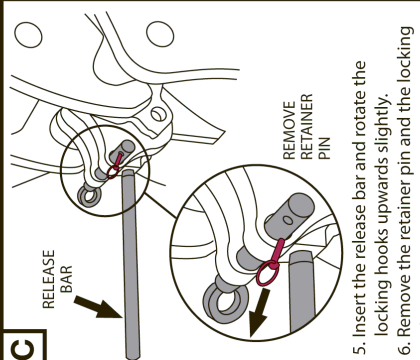
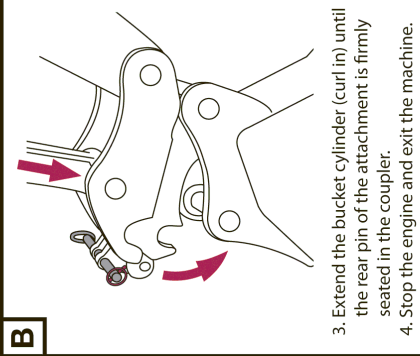
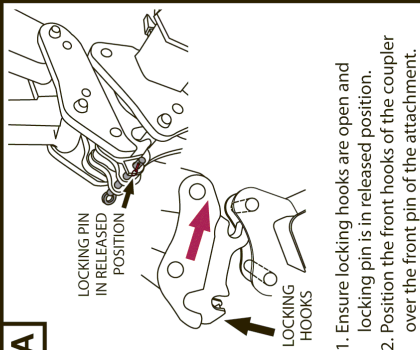

TO REMOVE THE ATTACHMENT

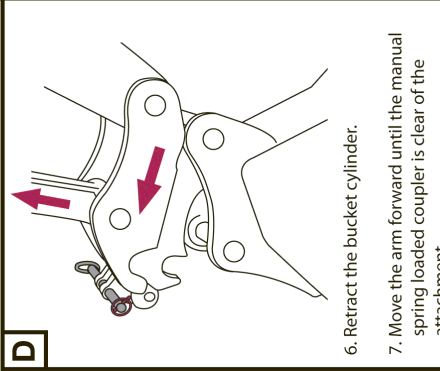
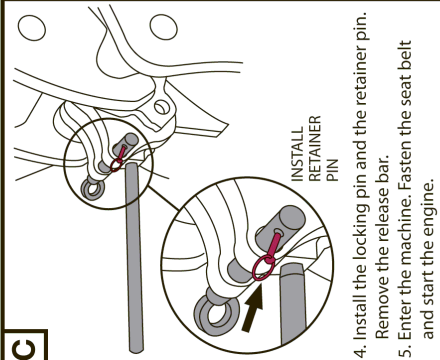
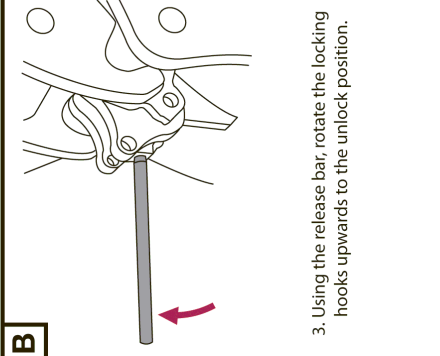
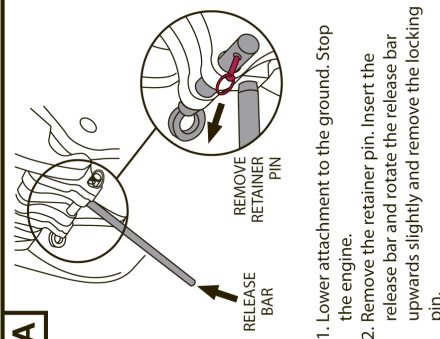

SEE MANUAL FOR MORE INSTRUCTIONS

67183 SW

7130241 enUS
* 7130241 enITC *

UNLOCKED VS LOCKED

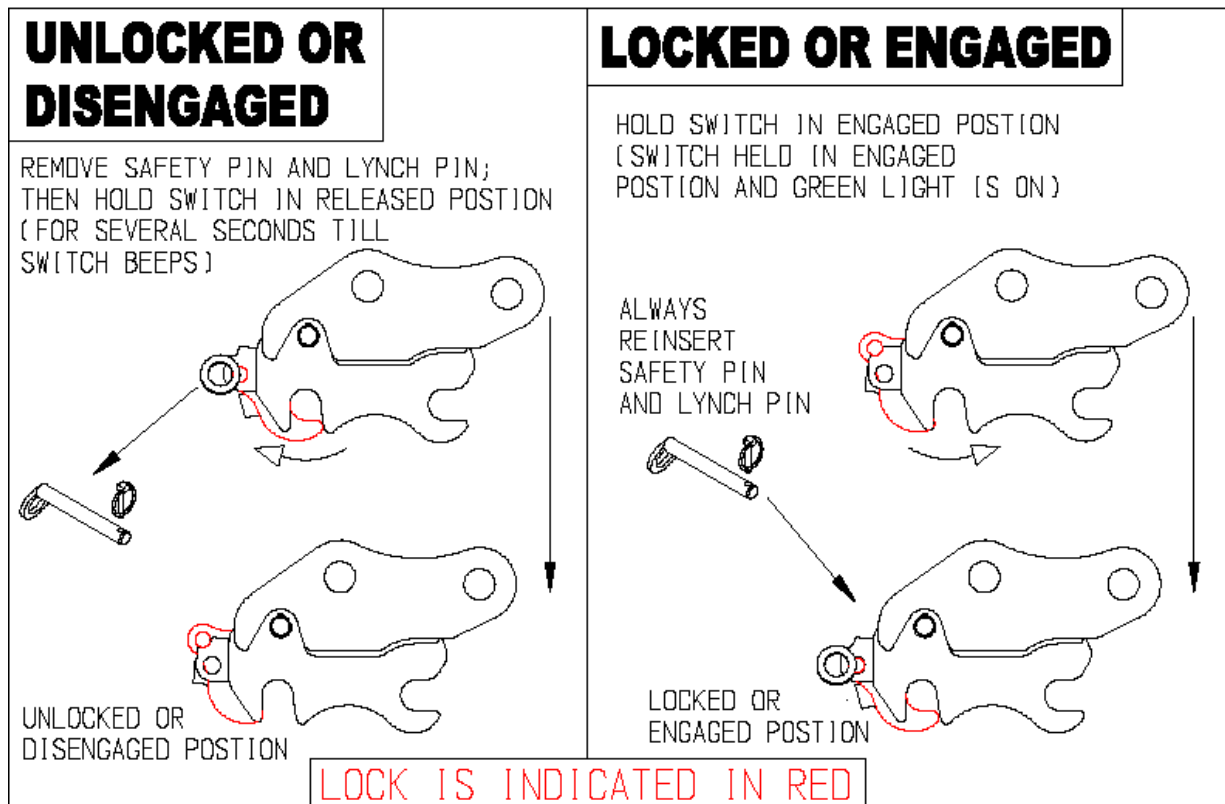
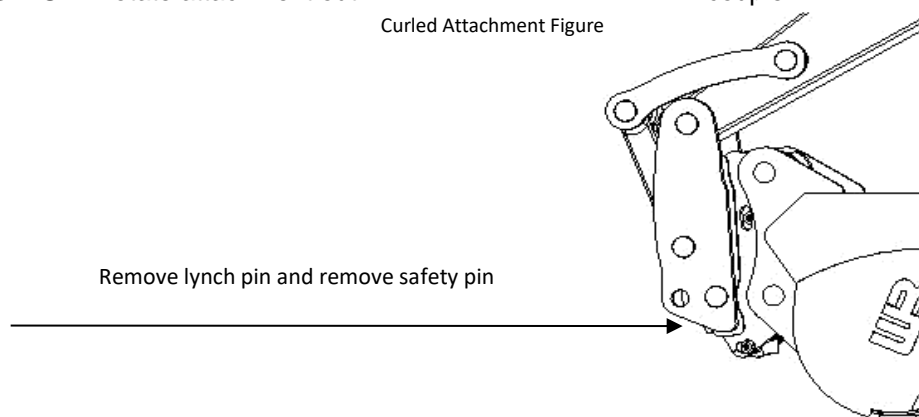

Figure: Safety pin installed with lynch pin

RELEASING AN ATTACHMENT

Rotate attachment in full curl position as far as possible, remove lynch pin and remove safety pin (See figure below). Put switch in “unlock” or “disengage” position. Be sure to have the attachment is clear from by-standers and on the ground prior to “releasing” the attachment. And will “hold” the coupler in the disengaged position while moving from one attachment to another. **DO NOT OPERATE COUPLER IN THIS POSITION.** Rotate attachment outward. Allow it to release from coupler.

Curled Attachment Figure









DECAL PLACEMENT GUIDE

PLACEMENT OF THE WARNING/CAUTION DECAL

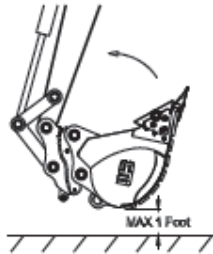
Place the warning/caution decal inside the cab, in a visible area for the operator can see at all times. This will act as a safety reminder for the operator to double check and ensure that the coupler's correctly hooked up to the attachment.

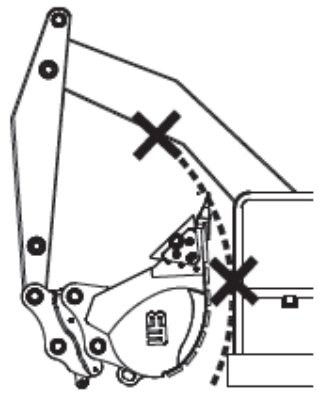
 DANGER	
	<p>CRUSH HAZARD. Attachment may drop without warning if not properly attached. Consult owners manual for proper installation procedures. Failure to comply could result in death or serious injury.</p>
	<p>Attachment must be disengaged in the fully curled position. NEVER activate switch in any other attachment position.</p>
 WARNING	
	<p>This machine is fitted with a quick coupler. This may lead to interference with the machine.</p>

MAINTENANCE, SPRING ADJUSTMENT – REPLACEMENT & TROUBLESHOOTING

MAINTENANCE:

Inspect coupler occasionally to ensure years of rugged service. There is a grease-zerk located on the lock. Grease as needed. With the proper servicing and adjustment, your Werk-Brau coupler should last years to come.

The following list below should be followed in order to lengthen the life of your WERK-BRAU product.

PROCEDURE	INTERVAL	NOTE
GREASE FITTINGS	WEEKLY	
CHECK SLQT SPRING(S) & PINS	DAILY	
INSPECT LOCKING MECHANISM	DAILY	

SPRING ADJUSTMENT/REPLACEMENT

ADJUSTMENT

If lock is not holding to the pin tight, tighten the spring nut(s) 2-3 more turns after spring is taunt in place. Over time, the spring will stretch and need tightened.

SPRING REPLACEMENT

1. Remove old spring.
2. Loosen or remove spring nut to allow for play in spring bolt.
3. Hook spring through groove in spring pin.
4. Hook spring through eye of spring bolt.
5. Tighten spring nut on spring bolt so that spring is taunt and then tighten 2-3 more turns.

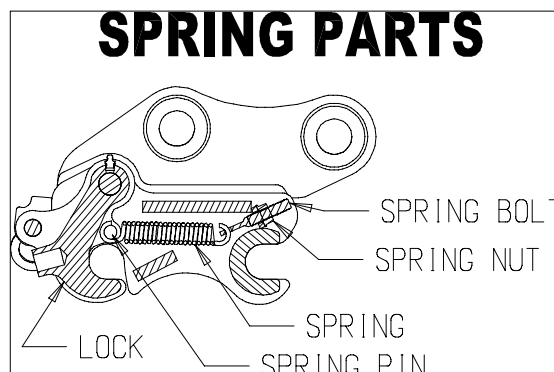

TROUBLESHOOTING

Problem #1

Locking mechanism will not retract.

Potential Cause / Corrective Action

A.) Foreign debris have caused locking mechanism to bind.

B.) Safety pin is engaged- remove safety pin and lynch pin.

Problem # 2

Lock will not engage properly.

Potential Cause / Corrective Action

A.) Foreign debris have caused locking mechanism to bind.

B.) Verify that the attachment pin centers match that of the coupler.

C.) Verify that the coupler is not contacting the attachment

Should you require any assistance or technical support, installation assistance is available by calling: 1-800-537-9561

NOTICE

Please reference U.S. Department of Labor SHIB 07-22-2005 for information in regards to hazards associated with misuse of quick coupling devices.

Werk-Brau Co. INC.,
2800 Fostoria Rd
P.O. Box 545
Findlay, Ohio
45839

For replacement parts, questions,
and other matters please call your
local dealer. If you can not reach a
local dealer please call us and we
will be happy to find a dealer for
you and answer any questions.

PHONE:

1-800-537-9561
Engage with us!



Facebook & LinkedIn

Record of Revisions

Revision	Date	Notes
B	6/24/08	Added notice for coupler extending TR Page 5
C	2/3/11	Removed Components
D	7/20/12	Edited layout, added safety pin page, added header, and edited footer.
E	7/7/21	Edited layout and formatted. Added SQC.

ABOUT WERK-BRAU

Since 1947, Werk-Brau has manufactured the highest quality and most innovative specialty products for the heavy equipment industry. Werk-Brau is respected internationally for providing outstanding customer service and being dedicated to excellence in all aspects of our business. Duke Werkheiser and Dutch Brautigan, for whom the company is named after, first opened their blacksmith shop in Findlay Ohio. Still today Werk-Brau manufactures and produces in Findlay Ohio, in a state of the art facility.

Over the decades Werk-Brau has grown and become so much more than a simple blacksmith operation. Today Werk-Brau proudly employs an industry leading team of professionals who work hard to follow the vision set by the founders of Werk-Brau to "Provide Excellence in Customer Service". As a modern company Werk-Brau is efficient, high-tech, dedicated to its customers, and deeply proud of the quality of products manufactured.

Werk-Brau manufactures a complete line of O.E.M. and replacement attachments for excavators, mini excavators, backhoes, skid steers, mini and full size loaders and crawler loaders. All over the world Werk-Brau attachments can be found hard at work in the toughest of conditions.

THANK YOU FOR YOUR PURCHASE!

WORK SAFE!

To learn more about your Warranty
please visit:
<http://www.werk-brau.com/warranty-claims>

To file a Warranty Claim
please visit:
<http://www.werk-brau.com/warranty-claims/form>

Or Call:
1-800-537-9561

TOUGH JOBS DEMAND TOUGH ATTACHMENTS



WERK-BRAU CO. INC.,
2800 Fostoria Rd
P.O. Box 545
Findlay, Ohio 45839

1-800-537-9561 *phone*
419-422-7207 *fax*
Werk-Brau.com