

# Klac industrie



**Notice d'utilisation et d'entretien**

**Instructions for use and maintenance**

## Klac +

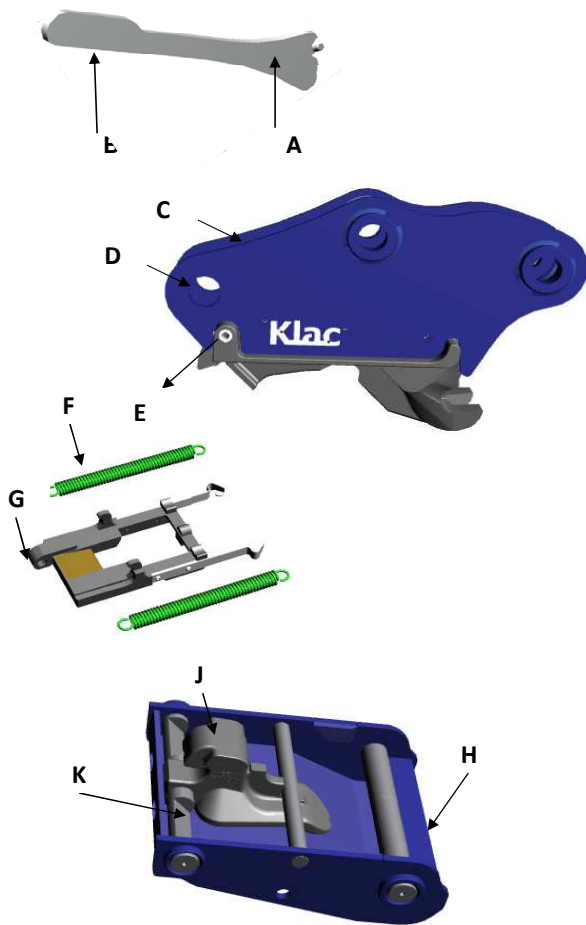



 	
<b>Klac industrie</b>	
Modèle Model	██████████
Réf. Ref.	██████████
N° Série Serial N°	██████████
Année Year	██████████
Poids Weight	██████████ Kgs
Pression Pressure	██████████ Maxi Bars
www.klac-industrie.com	
Tél : (33) 02 38 49 82 82	
Fax : (33) 02 38 49 82 83	

### Wording for Klac +

#### Unlocking key

A : Wrench stud

B : Handle

#### Klac + mechanical quick coupler

C : Bracket

D : Handling rings

E : Spindle

F : Spring

G : Locking plate

#### The Kit

H : Head

J : Locking block

K : Sloping plane

### 1°) Receipt

On receipt of your coupler check that the model and the references indicated on the identification plate "L" correspond to your machine.

During the setting up, make sure that the part supplied with your machine is compatible

Besides the coupler, the parcel must contain this instruction for use, the unlocking key, the EC certificate.

Before using an accessory check that its total weight when loaded DOES NOT EXCEED the lifting capacity of the machine being used

## I- Fixing of the coupler Klac + to the machine

The coupler is generally supplied without pins. The original ones will be used. If the original pins would not fit in a set of pins will be delivered with the coupler.

Fixing is relatively standard, and consists in putting the 2 pins in the bores and in the balance boom. This operation **MUST** be carried out while wearing working gloves and usual job site equipment (helmet etc). Then insert the rocker shaft and fix the pins with the stop pins system proposed by the manufacturer.

*The couplers have sometimes 2 bores either in the balance boom or in the link. You have to test the best position.*

## II- Unlocking - key use

**!!!!!!!!!!!! IMPORTANT !!!!!!!!!!!!!**

Before taking the bucket, or an accessory, we must re-engage the locking plate.

Pull the handle to unlock and when the key is pulled to the maximum, put the plate in a crash stop position

The bucket has already tipped up on the spindle. Remove the key and put it in the cab.

### UNLOCKING AN ATTACHMENT

Place the attachment in order to have a 20° opening (exemple with a standard bucket)

Use the key as explained previously.

The effectiveness of the locking leads to a more and more efficient jamming of the locking plate. So as to release the system hold the wrench halfway down the handle (left-hand diagram) and strike several times repeatedly for easy locking.

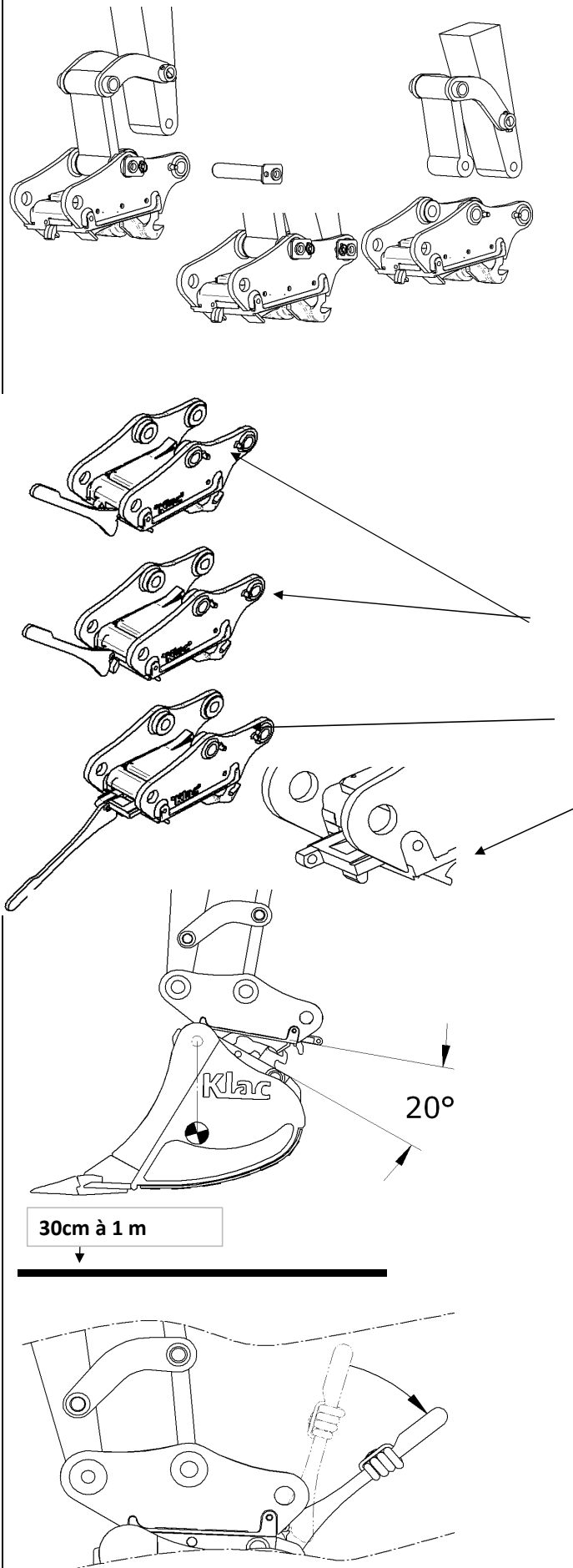

### III - Disengagement of attachments

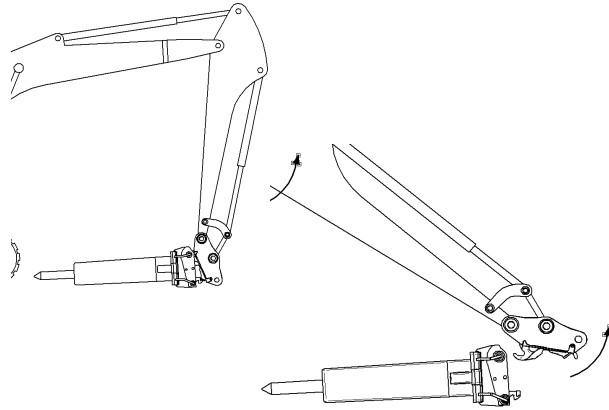
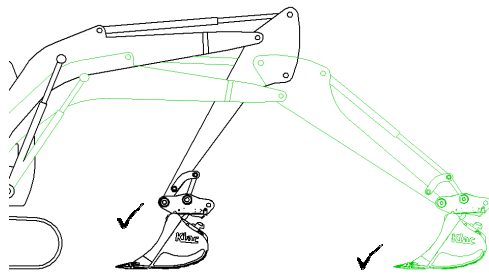

**Klac+** allows disengagement of ALL attachments in ANY surrounding of the machine.

After unlocking as explained previously, the attachment is put down. By retracting the digging cylinder the attachment is released.

if your attachment is provided with hydraulic hoses it is recommended to unplug them before releasing the attachment. place the hoses in order to protect them.

Lay the attachment down and disengage the coupler.

### IV - Handling

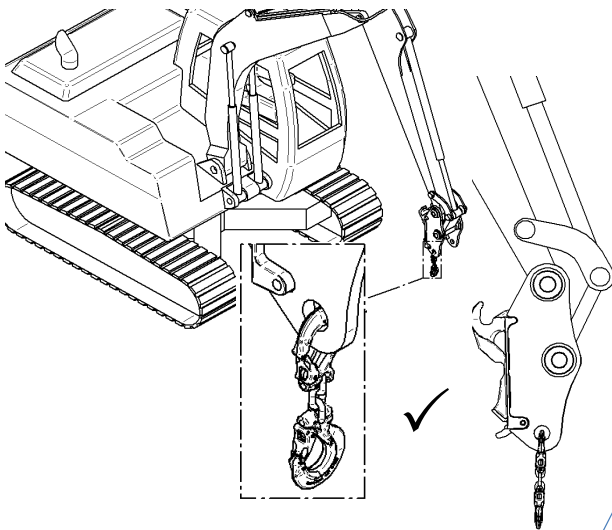

Handling is to achieve without attachments and the machine must be homologated for handling. The rear rings on the brackets are designed to be used with hooks. Ideally the sling should be aligned with the axis of the balance to limit your efforts on lifting cylinder The sling should never interfere with the attachment! Certified slings complying with the European Directive 2006/42 / EC are available in option:



Modèle	CMU*
G	<b>4 000 Kg</b>
H	<b>6 700 Kg</b>
I	<b>10 000 Kg</b>



\* Charge Maximum Utile.

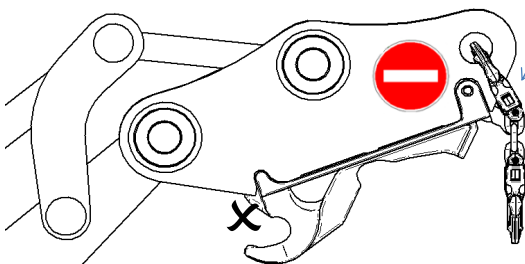

if the lifting capacity of your machine is lower,  
**DO NOT EXCEED THE LIFTING CAPACITY OF YOUR MACHINE**

U

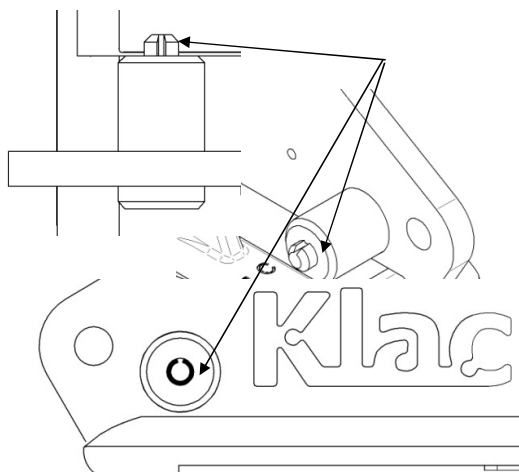
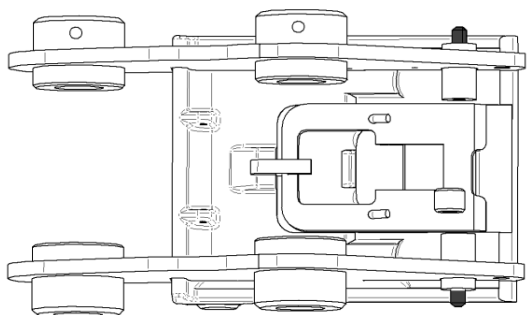
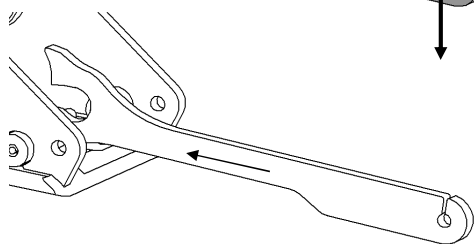
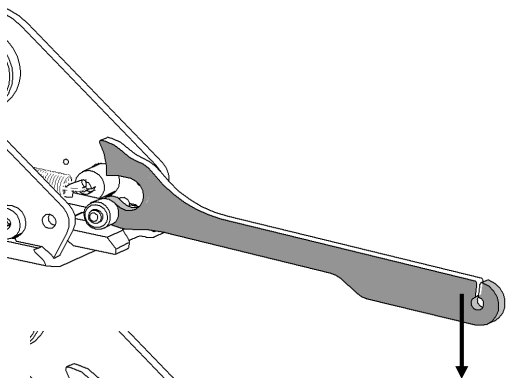
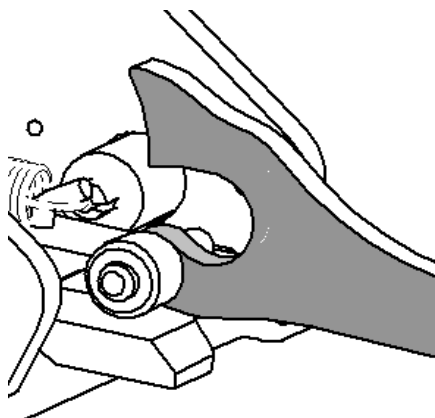

## 7°) Maintenance

Klac + needs no particular maintenance. No greasing, no adjusting. The maintenance can consist of changing a damaged or broken spring.  
The springs are not symmetrical. They have different ends.

### *Dismantling of the locking plate*

**CAUTION, IF YOU HAVE TO REMOVE THE PLATE, NEVER REMOVE THE SPLIT PINS BEFORE THE SPRINGS. To remove the springs it will be necessary to "disarm" the locking plate:**

### *Dismantling procedure:*

Insert the key the other way around in the locking plate's hole, as shown in U and push the key to engage the plate. Follow the key during the whole course.

**NEVER OPERATE IN THE MECHANISM OF MECHANICAL or HYDRAULIC QUICK COUPLERS WITH THE LOCKING PLATE ENGAGED**

Remove the springs of the locking plate, then the two split pins to the outside. The quick hitch is dismantled.

You just have to take the locking plate off.

### *Reassembling of the Quick coupler*

Insert the locking plate (if it has been removed), push back the two split pins slot up **IMPERATIVELY!** before assembling the springs. Fit the spring following the next page method..../

**Do not grease your Klac +**

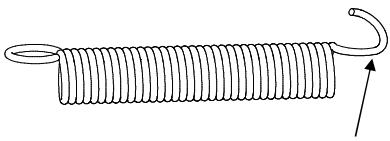

standard loop

special loop

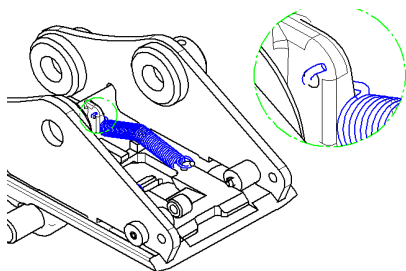
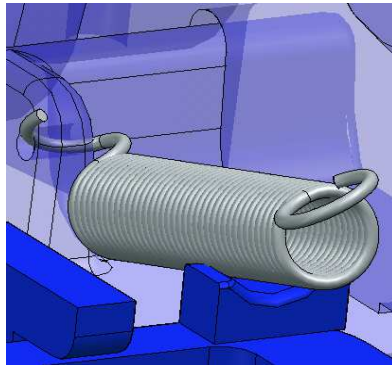

The standard bucle is centred on several models

Put the spring point downwards then turn of 90°

Correct position after rotation

Engage the second ending

Same thing for 2nd spring

**Do not grease**

**NOTES**